

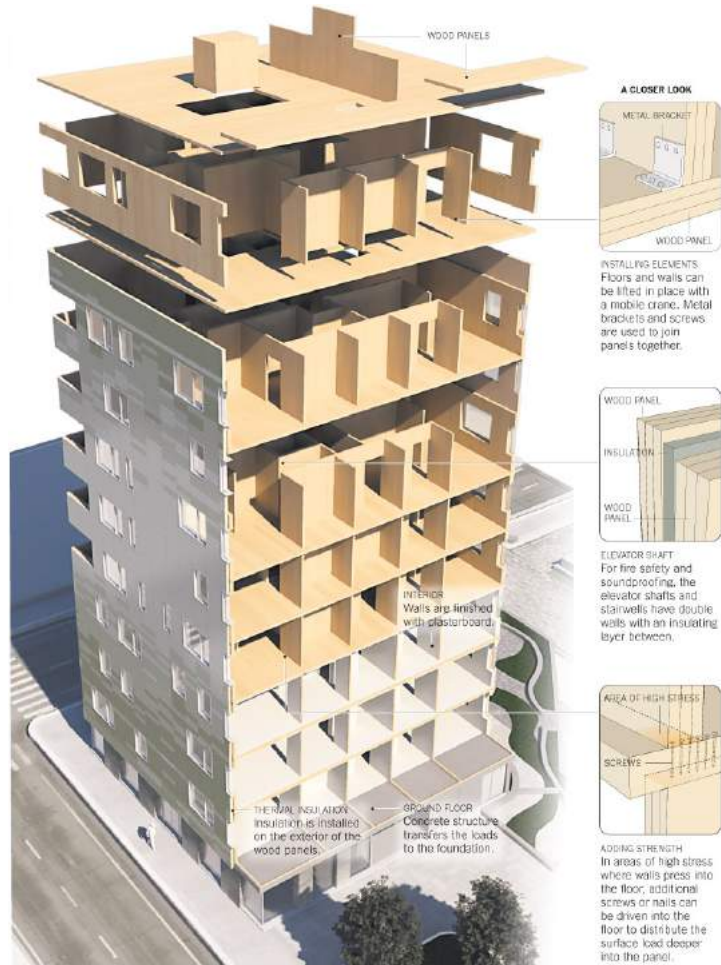

Wood is CO₂ – neutral and is the only renewable building resource.
Using more CLT reduces considerably the CO₂ emissions in buildings.

Crosslaminated timber – for whom and for what?



30.11.16

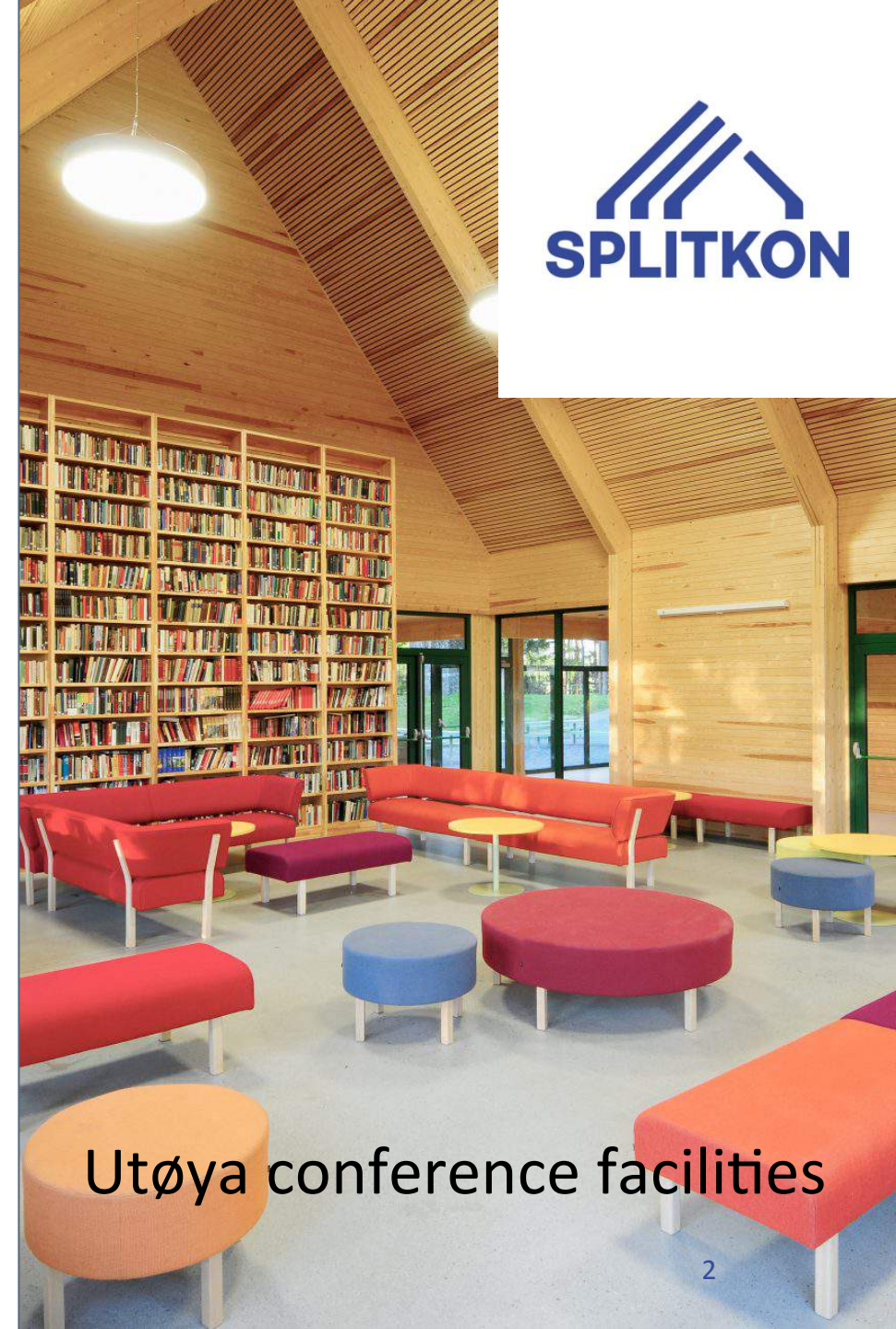

Utøya conference facilities

Klimagassberegninger til å velge løsninger



(Kilde: Presentasjon fra Eggen Arkitekter)

Any political instruments to make wood more applicable?

- Increased demand due to design and environmental properties
- Green construction standards, BREAM-NOR
- Official bodies can be substantial market operators

New CLT facility in Åmot, Norway



Building materials made in Norway
using Norwegian timber – future
buildings made greener

